

This map is based on Ordnance Survey material with the permission of the Controller of Her Majesty's Stationery Office. Crown Copyright. Unauthorised reproduction of this map is prohibited. All rights reserved. EAST SOMERSET COUNCIL Licence No. 100023334

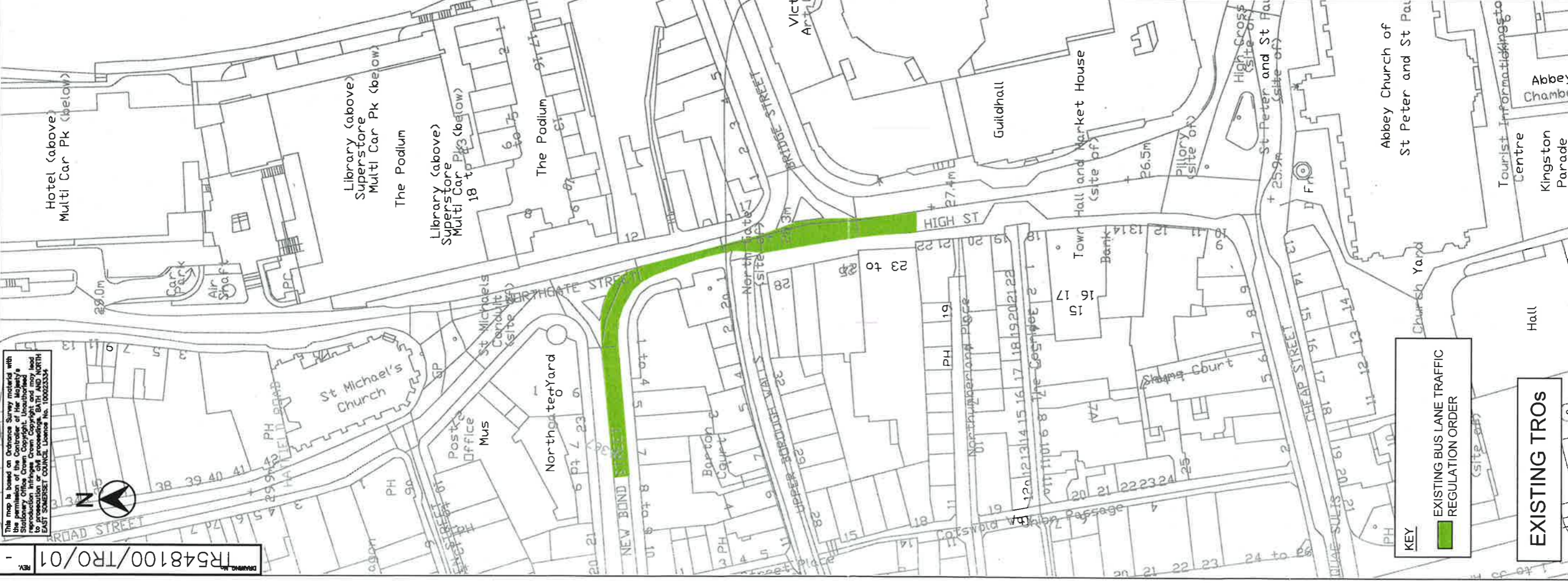
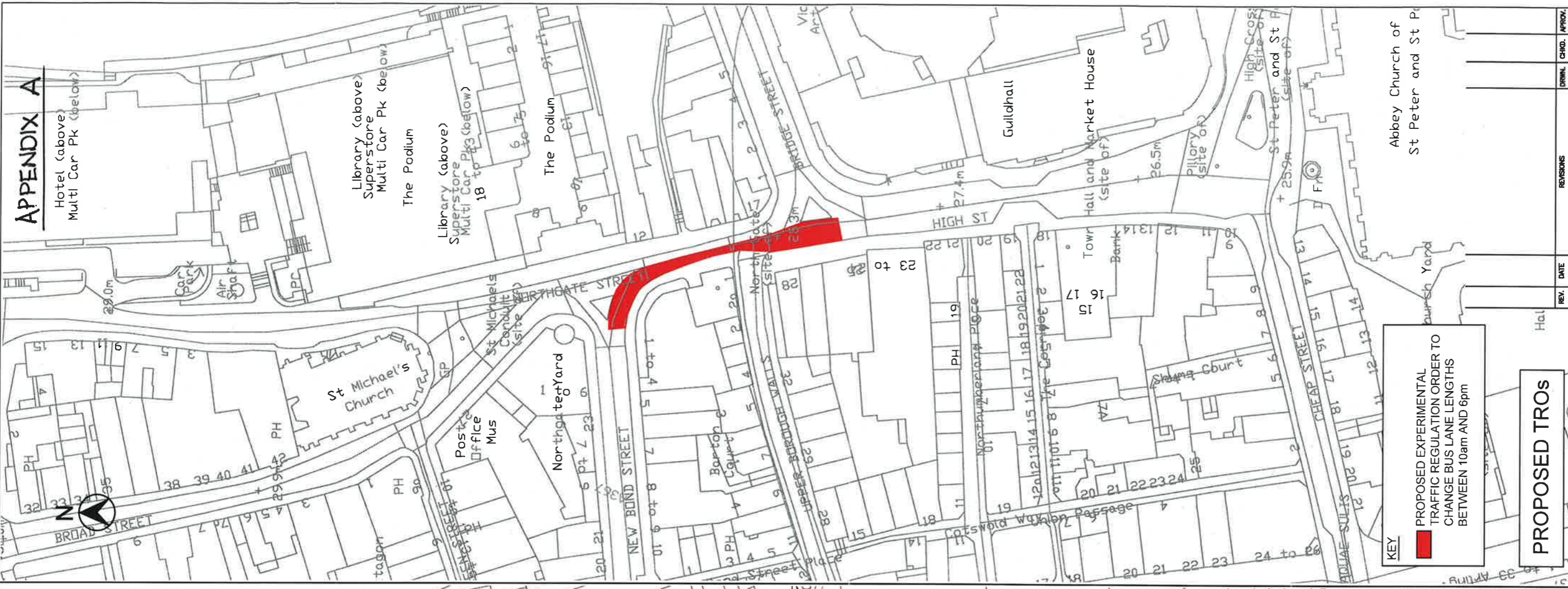

**KEY**  
 PROPOSED EXPERIMENTAL TRAFFIC REGULATION ORDER TO CHANGE BUS LANE LENGTHS BETWEEN 10am AND 6pm

**PROPOSED TROS**

**KEY**  
 EXISTING BUS LANE TRAFFIC REGULATION ORDER

**EXISTING TROS**

DRAWING NO. <b>TR548100/TR0/01</b> REV. -	DATE JAN 2012 SCALE 1:1000@A3 CLIENT REF.	DRAWN BY TRH CHECKED ST	APPROVED BY SRC DRWN. CHGD. APPRO.
	REVISIONS		
PROPOSED CHANGE TO BUS LANE LENGTHS ON HIGH STREET AND NEW BOND STREET BUS GATE ACCESS POINTS, BATH		EXISTING AND PROPOSED TRAFFIC REGULATION ORDERS	
DESIGN GROUP		PRODUCED BY	
Bath & North East Somerset Council SERVICE MANAGER - HIGHWAYS AND PARKING KELVIN PACKER ENVIRONMENTAL SERVICES		ABBEY CHURCH OF ST PETER AND ST PAUL Tourist Information Centre Kingston Parade	